

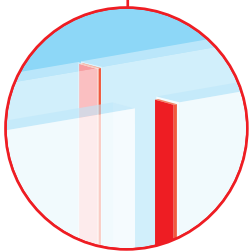

PERFECT FIT FOR INTERIOR FIT-OUT

Our Bonding Solutions for Maximized Efficiency

OFFICE PARTITIONS



Glass to glass

e.g. office partitions

Application requirements

- Immediate bonding
- Invisible joint possible
- Excellent resistance against UV, temperature, humidity and chemicals
- Complete seal mitigating noise and smell transfer
- Compensation of uneven surface (glass)

Product recommendation

tesa® ACX^{plus} 704x
tesa® ACX^{plus} 705x
tesa® ACX^{plus} 707x

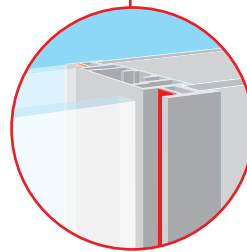

Glass in frame

e.g. office partitions
and clean rooms

Application requirements

- Immediate bonding on glass, profile or frame materials such as plastics, aluminum or wood
- Excellent resistance against UV, temperature, humidity and chemicals

Product recommendation

tesa® ACX^{plus} 704x
tesa® ACX^{plus} 705x
tesa® ACX^{plus} 707x



tesa® ACX^{plus} 7078, tesa® ACX^{plus} 7058

Compatibility of tesa® ACX^{plus} and PVB foil of laminated safety glass

- Report No. 13-000979-PR01
- Report No. 13-000979-PR02



tesa® ACX^{plus} 7078

Sound reduction test

- Report No. 82013-LACUS-IN-40 T2



Clear Advantages

in Productivity,
Durability
and Design

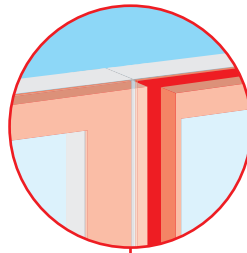

Glass to frame
(flush design)

e.g. glass partitions and clean rooms

Application requirements

- Immediate bonding on glass, powder coats or aluminum
- Stable bond to keep glass panel in place
- Possible to achieve a flush design: optical tape coverage not needed
- tesa tools for bubble free application on glass

Product recommendation

tesa® ACX^{plus} 704x

tesa® ACX^{plus} 707x

tesa® ACX^{plus} 709x

tesa® 636xx



tecnalia

tesa® ACX^{plus} 7078

Safety in use, mechanical resistance and stability tests
according to ETAG003

- Report No. 4_04922

INTERIOR WALL CLADDING

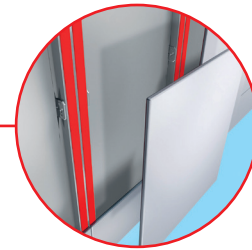

Panels/mirrors to wall

e.g. interior decoration for commercial buildings and hotels

Application requirements

- Immediate bonding on different substrates (panel and substructure)
- Stable bond to keep panel in place
- High shear resistance when bonding larger/heavy elements

Product recommendation

tesa® 62936 or 636xx (for smaller panels < 1.5 m)
tesa® ACX^{plus} 707x

Taking your
Processes
to the **Next Level**



tesa® 62936

Confirms longterm adhesion performance after IEC 61215/61646 climate tests and a 85°C temperature resistance.

- Report No. 21209595



tesa® 62936

Confirms mechanical strength tested at low & elevated temperature after temperature/UV aging and after aging in water/cleaning solution.

- Report No. 10-000666-PB01-K01-09-en-02



FLOORING

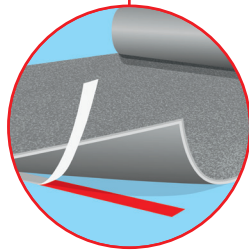

Permanent fixing of flooring materials

Application requirements

- Secure bonding of rough and fibrous material, e.g. carpets
- Reliable mounting of planks, sheets or tiles made of different material (vinyl, wood, laminates etc.)
- Excellent outdoor resistance if needed

Product recommendation

tesa® 4939 (carpet and vinyl)
tesa® 625xx (planks)

Benefits of working with tapes

			Double-sided tapes	Liquid glue	Mechanical fastening (e.g. rivets, screws, nails)
Design		Improved visual appearance – no damage to the material	••••	•••	•
		Invisible fastening – mounting of transparent materials	••••	•••	•
Assembly		Fast application process – elimination of curing time and reduction of complexity	••••	•	••
		Healthy working environment and clean production sites	••••	••	••
Quality		Compensation of irregular or uneven surfaces – gaps between bonded surfaces are eliminated	•••	••••	•
		Compensation of tension and stress dissipation – single bonding point with mechanical fasteners can lead to material breakage	••••	••	•
		Noise-dampening properties – sounds caused by vibration are eliminated	••••	•••	•
		Shock absorption	••••	••	•
		Sealing function – tape seals and protects against dust and moisture	••••	••••	••
		Reduced risk of corrosion	••••	••••	•

•••• Very good ••• Good •• Medium • Low

HEATED AND CHILLED CEILINGS

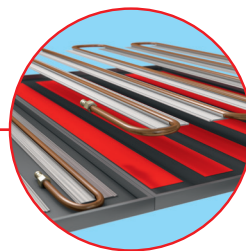
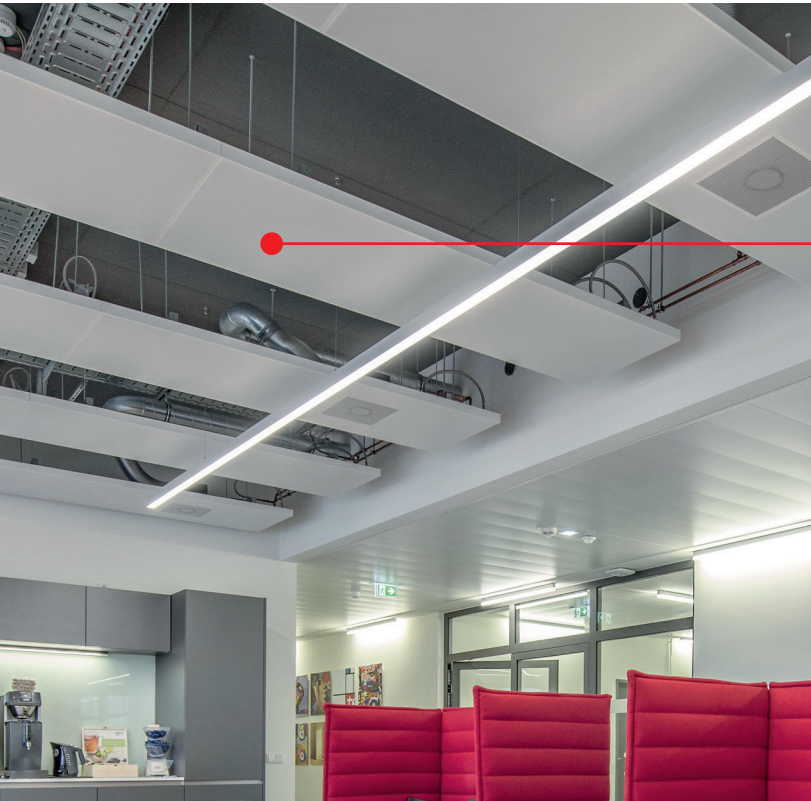

Bonding of heat conducting rails

Application requirements

- High thermal conductivity
- Immediate bonding on metal surfaces
- Black PET backing available

Product recommendation

tesa® 4943

tesa® 51982

Improved processes with engineered tools

Our solutions go beyond tape. We provide technical consulting and proven application tools, in order to implement a fast and reliable production process at our customers. tesa® application systems are easy to use and enable constant quality. We are scaling them depending on production output and complexity. Benefit from an individual and cost-efficient solution.

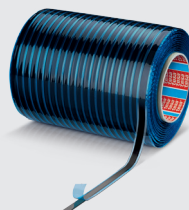
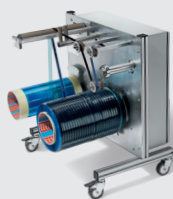
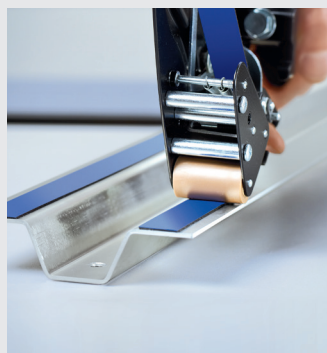

Technical product information

Product	Backing	Adhesive type	Color	Liner	Thickness [µm]	Temperature resistance short/long [°C]	Ultimate adhesion to steel [N/cm]	Additional thicknesses [µm]
Double-sided adhesive tapes								
tesa® ACX ^{plus} 7048	Foamed acrylic	Pure acrylic	Gray/white	Filmic	2000	170/120	38	500, 1000, 1500
tesa® ACX ^{plus} 7058	Solid acrylic	Pure acrylic	Transparent	Filmic/paper	2000	200/100	29	500, 1000, 1500, 3000
tesa® ACX ^{plus} 7078	Foamed acrylic	Pure acrylic	Black	Filmic/paper	2000	220/120	40	500, 1000, 1500
tesa® 62510	PE foam	Tackified acrylic	Black/white	Filmic/paper	1000	80/80	13.5	500, 800, 1100, 1200, 1600
tesa® 62936	PE foam	Tackified acrylic	Black/white	Filmic/paper	1600	80/80	19	500, 800
tesa® 4939	Cloth	Synthetic rubber	White	Glassine	250	80/40	5.5	–
tesa® 4943	Non woven	Tackified acrylic	Transparent	Paper	100	100/70	8.1	–
tesa® 51982	PET film	Tackified acrylic	Black	Filmic/paper	100	200/100	11.7	–

New product feature creates benefits for partition wall applications

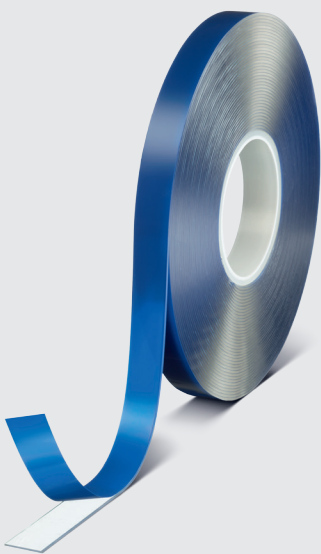

Adhesive Neutralized Edges

We invented a process of applying a very thin glass-like layer to the edges of tape rolls. With our process we offer our customers a highly transparent tape with Adhesive Neutralized Edges:

- tesa® ACX^{plus} 7058
 - tesa® ACX^{plus} 75530
- are optionally available with this feature.

Benefits

- Easy handling of tape rolls in the assembly process
- Tape edges stay free of contamination from dust or dirt
- Premium optical appearance of the mounted partition wall
- Easy cleaning after installation



© Ron Blunt

12/2016



Our management system is certified according to the standards ISO 9001, ISO/TS 16949, and ISO 14001.